



For Lease

345 METTY Drive

SCIO TOWNSHIP, ANN ARBOR, MICHIGAN

9,600 to 19,200 Flex space available

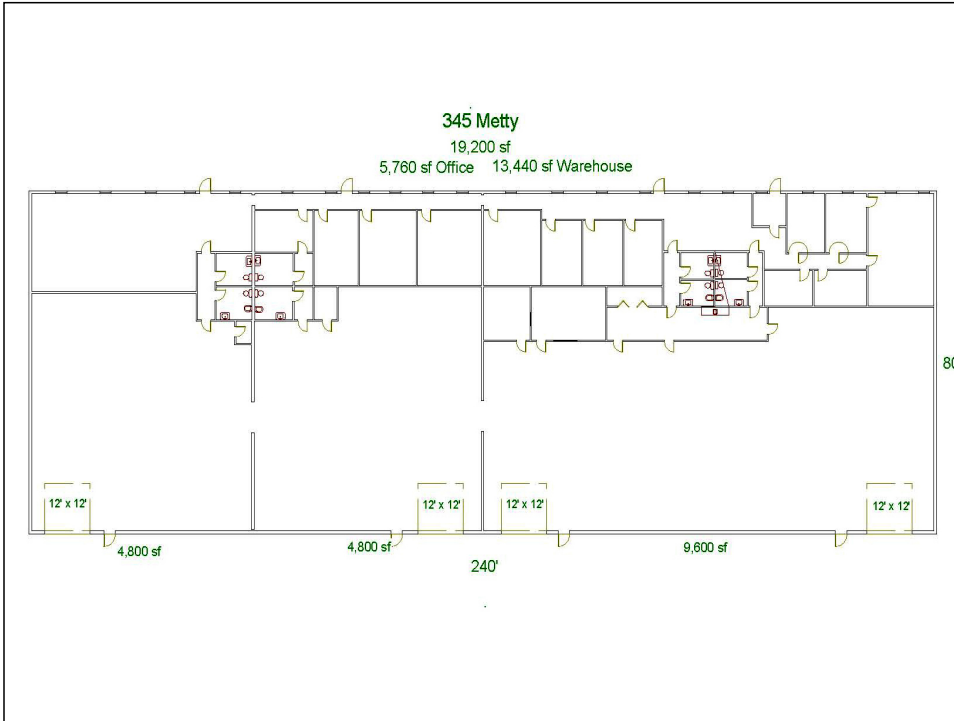

LOCATION: Conveniently located in Scio Commerce Center, off Jackson Avenue between Baker and Zeeb. Easy access to I-94 and M-14 with close proximity to US-23. Ann Arbor address with township taxes!

ZONING: I-1, Light Industrial, Scio Township, 734-665-2123

PARKING: At the door parking

LEASE TERMS: 36 Months

BUILDING: Built 1984, this attractive single story building is 19,200 sf with 5,760 SF of office space, and 13,440 SF of manufacturing space. Can be split up into minimum suite sizes of 9,600 sf.

LEASE RATE: \$5.95/sf NNN. Tax, insurance, and CAM is \$2.20/sf, for a total monthly rent of \$13,040.

Manufacturing space is easily accessible from offices. Ceiling height is 14', features four 12' x 12' overhead doors and 800 amps of 208 volt 3-phase electric. Gas fired radiant tube heat.

Contact: **John Evans**
David Hamilton, CCIM

direct: 734-662-3682
direct: 734-662-3745

evans@swishercommercial.com
daveh@swishercommercial.com

Building relationships.



208 East Washington St. Ann Arbor, MI 48104
tel: 734.663.0501 fax: 734.663.0316
www.swishercommercial.com